



Folding doors

Suitable for transit in industrial and commercial environments of small and large dimensions and in particular in situations where a safety closure is required. Perfectly matched with the entire range of COIL rapid doors, they are a reliable and functional closing system. COIL folding doors are available in the versions with opening to one or more panels, with or without floor guide to be walled up and with upper bearing guide, with manual or motorized opening, extremely easy to handle and silent.



Panels

Foamed

Structural panel thickness 52 mmV insulated with injected polyurethane foam with a density of 43 kg/m³ (U value of the central homogeneous zone 0.457 W/sqm K).

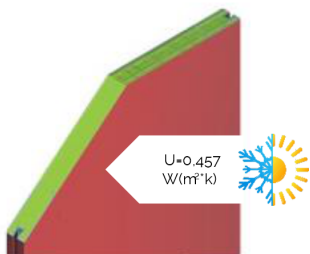

Cushioned Doors with Panel

50 mm thick steel door (cold profile painted and buffered with 25 mm thick insulated panel)

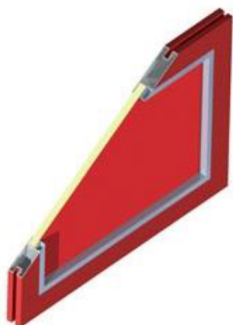

Doors with glass panels

Door thickness 50 mm in steel (cold profile painted and prepared for tamponade with glass of various sizes, from 6/7 mm up to 28)



Standard colours

Our panels are covered on both sides with 7-8/10 thick pre-painted steel smooth sheet metal, available in RAL-like colours.

On request we can cover the panels with stainless steel sheet (Aisi 304 or 316), with pre-painted aluminium sheet or galvanized sheet painted RAL of your choice.

Please note that the colours in this catalogue may differ from reality.



Semi standard colours



Folding doors with floor guide

Door with several leafs, with one or two folding opening, with no floor guide, are made of galvanized steel tubular anodised aluminum with galvanized sheet panels, insulated internally with expanded polyurethane, for a total thickness of 52.

The doors are joined by galvanized steel hinges, stainless steel screws, steel pins and trolleys and 50 mm anti-crush EPDM rubber gaskets, upper and lower brushes in wear-resistant nylon.

The manual closing is done by means of a 2-point handle. Depending on the need, the assembly can be done in light or out of light, inside or outside the building. At the time of delivery, the doors are protected by semi-adhesive protective film to be removed after installation.

Versions on demand

- pedestrian walkway (safety exit)
- panic bar
- safety lock
- round window
- ventilation grilles
- predisposition to motorization
- electrical operation

Technical specification

The folding door with lower and upper load-bearing guide is composed of a 52 mm thick panel with an internal perimeter frame in galvanized steel, insulated with injected polyurethane foam with a density of 43 kg / m³ and covered on both sides with pre-painted smooth sheet metal, with a thickness of 7-8 / 10, available in the various colours of the range.

The upper guide in drawn steel, 40/10 thick, is of the load-bearing type and is composed of a side flag for leaves collection, a duct for diverters sliding, brackets for wall fixing and four-wheeled steel carriages for sliding.

The perfect movement of the doors is guaranteed by the black aluminium hinges, complete with anti-fall system pin and double bearing; the upper carriages have four steel wheels.

The lower guide (to be embedded in the floor - by the customer), is of the "U" type in extruded steel and is supplied with a positioning scheme to allow the customer the perfect installation and ensure the right axis from the wall.

The gaskets between the two leafs, designed to guarantee an anti-crushing space of 50 mm, are made of black, anti-ageing, natural EPDM rubber. In the upper and lower part of the leaves, black aluminium profiles are fixed with a special joint for the insertion of nylon brushes.

The doors are supplied with manual opening, while upon request they can be predisposed to the motorization or motorized.



Upper part folding door mounted over light

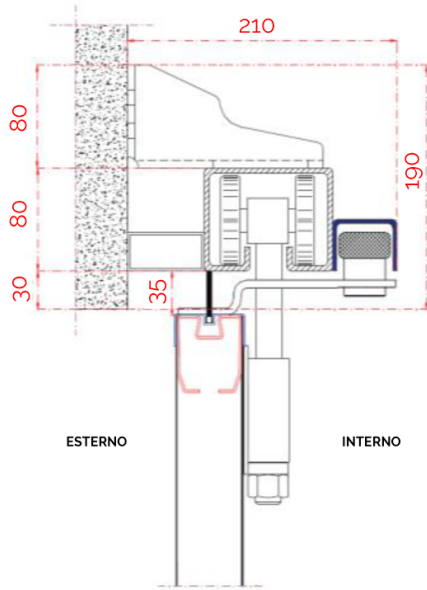

Detail of side closure beyond light

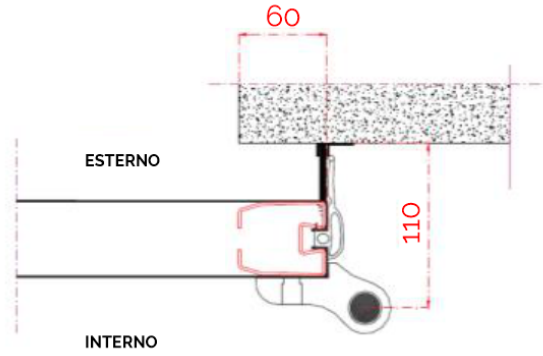

Upper part folding door mounted in light

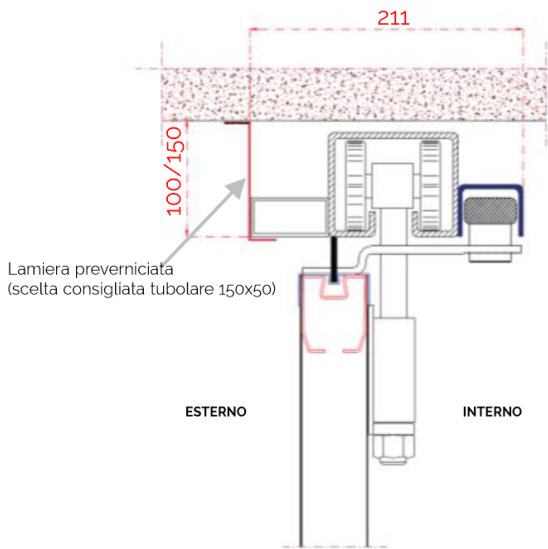

Bottom part of folding door mounted over light

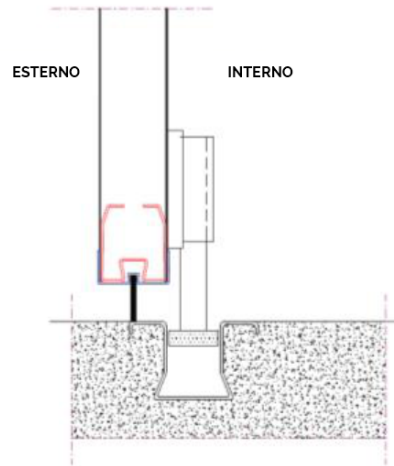

Detail of hinge between door and leaf

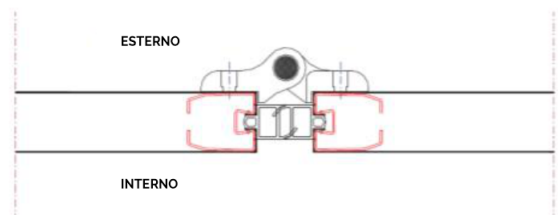

Detail of door strike beyond light

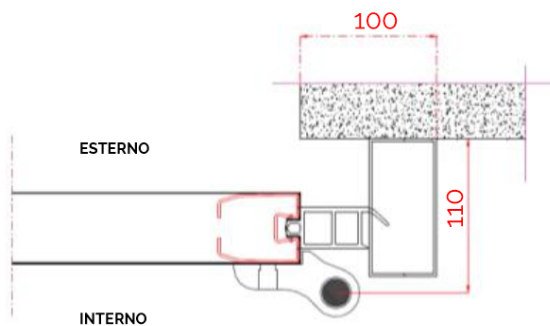

Folding doors without lower guide

The folding door without lower guide is made up of a 52 mm thick panel with a galvanised steel internal perimeter frame, insulated with injected polyurethane foam with a density of 43 kg/m³ and covered on both sides with pre-painted 7-8 /10 thick smooth sheet metal, available in various colours in the range.

The upper guide and the lateral uprights in galvanised steel, with a thickness of 20/10, are supplied in the standard version varnished in black.

Predisposed for mounting, they constitute a real structure for the door, allowing easy operations and guaranteeing a high degree of stability and tightness.

The perfect movement of the leaves is guaranteed by the black aluminium hinges, complete with anti-fall pin system and double bearing; the upper carriages have three or four steel wheels.

The gaskets between the two leaves are made of black, anti-aging EPDM natural rubber and guarantee an anti-crushing space of 50 mm. In the upper and lower part of the leaves, black aluminium profiles are fixed with a suitable slot for inserting the nylon brushes.

The doors are supplied manual, but on request they can be prepared for motorization or motorized - only for versions 2 + 0/2 + 1/2 + 2/4 + 0/4 + 2/4 + 4.



Upper part book door mounted over light

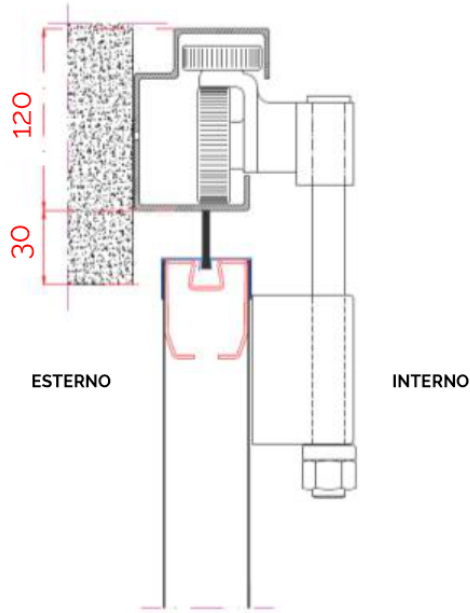

Lateral closure detail in over light

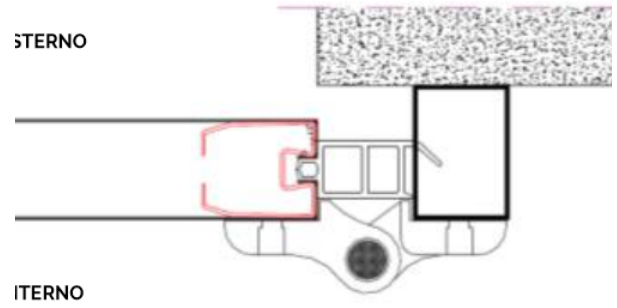

Upper part book door mounted in light

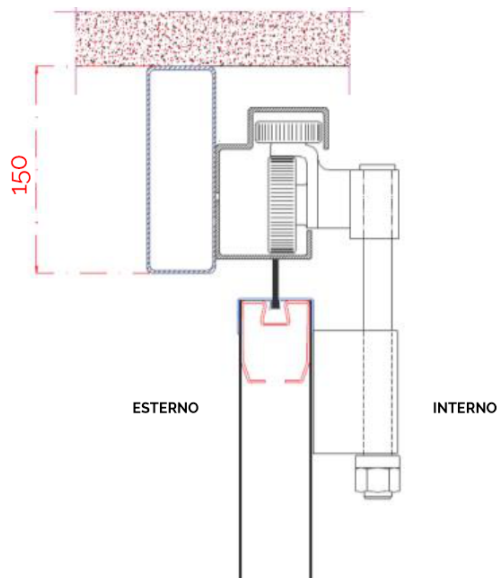

Lower folding door detail

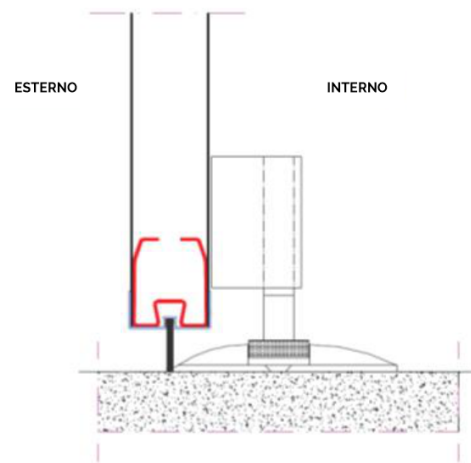

Hinge detail between the two leaves

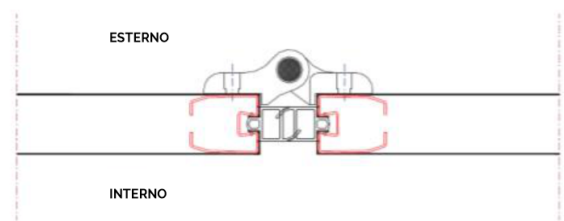

Lateral closure detail in light

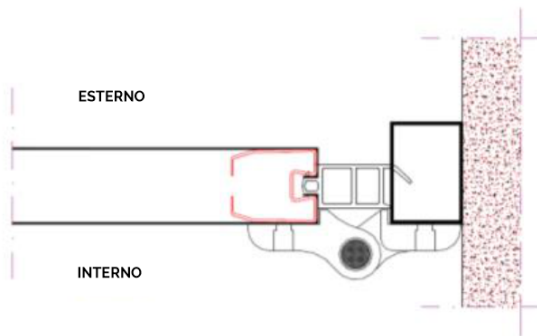

Warranty

Standard 12 months.

Built with the finest materials and electronic components, folding doors are tested in the most demanding applications of industry and commerce and are guaranteed for 12 (twelve) months from the date of delivery.

The warranty covers only and exclusively a free replacement at our site of components recognized as defective. It expires in the event of manipulation, modification and/or repairs carried out by unauthorised persons. All damage caused by carelessness, incorrect use or installation or in any case caused by events that are not caused by normal use is excluded.

Certifications

Product in compliance with the product standard UNI EN 13241:2016 Industrial and commercial closures. All COIL doors are supplied with original CE certificate.

CE certification ensures that construction and design of the product complies with requirements of the following safety directives:

- UNI EN 13241:2016 Product standard for Industrial and Commercial Closures
- 305/2011 Construction Products Directive
- 2014/35/EU Low Voltage Directive or LVD
- 2014/30/EU Electromagnetic Compatibility Directive or EMC Directive
- 2006/42/EC Machinery Directive
- UNI EN 12604 Mechanical aspects
- UNI EN 12453 Safety in use of motorized doors
- UNI EN 12424 Wind load resistance

Per maggiori informazioni:

Graflex S.r.l.
Via Risorgimento, 54
20017 RHO (Milano) - Italia

Ufficio Commerciale
Tel.: +39 0238203200
E-mail: sales@coil.it
www.coil.it

Accedi direttamente al sito COIL dal tuo smartphone con la scansione del QR code.



Nota : Le informazioni contenute nel presente documento sono descrittive e non costituiscono carattere contrattuale. In virtù della continua ricerca ed aggiornamento dei propri prodotti, Graflex Srl si riserva il diritto di modificare anche in parte le informazioni contenute nel presente documento senza preavviso.

COIL®